

**Prefabricated
lifting station
for wastewater
in compliance
with
EN 12050-1&2
standard**

**SINGLEBOX
PLUS
Series**



MARKET SECTORS

DOMESTIC.

APPLICATIONS

- Suitable for delivering gray water and wastewater to main sewer lines located at a higher level, or where gravity drainage is not possible.

SPECIFICATIONS

- The standard station is equipped with:
 - polyethylene **basin** with a capacity of 270 litres, equipped with a threaded pedestrian cover (100 kg max).
 - **Cable glands** for power supply cables (and floats).
 - Rp 1 1/2 or Rp 2 **delivery pipes** with fast connection and ring nut for easy disassembly of the pump or with sliding device.
 - **4 fast connections:**
2 x DN110 for inlet,
1 x DN50 for ventilation and
1 x DN65 for cable connection.
 - **1 x DN50** fast connection for the manual pump.
 - **DOMO** or **DL submersible pump**, vortex, channel impeller type or with grinder device.
 - **QDR control panel** for three-phase versions.
 - **3 rubber seal:**
1 x DN110, 1 x DN50 and
1 x DN65 mm.
 - Versions with **vortex impeller** or with **grinder device** suitable for:
 - clean water, effluent, sewage containing suspended solids and fibres.
 - Versions with **single or twin channel impeller** suitable for:
 - clean water, effluent, sewage containing suspended solids but not containing fibres.
 - Special versions equipped with delivery pipes, ball check valve and gate valve.
 - Special versions equipped with sliding device and non-return ball valve.
- **Singlebox plus** can be installed on the floor or buried in a suitable structure following instructions in the "Instructions and Operative Manual".
 - **Easy installation:**
 - installation is quick and easy: for the single-phase versions you just connect the pipes and the electrical cables; for the three-phase versions you also need to connect the control panel.
 - The new **Singlebox plus** is provided with side handles for ease of handling.
 - Pre-installed delivery pump and unions.
 - **Ecological solution:**
 - tank made from 100% recyclable polyethylene.
 - Airtight anti-pollution tank, pursuant to European standard EN 12050.
 - **Easy maintenance and repair.**
 - Tried and tested pump technology.
 - Pump quick and easy to remove thanks to the ring nut located near the cover.

ACCESSORIES

- Available accessories:
 - Ball check valves.
 - Alarm kit.
 - Manual pump + seal.
 - Seals kit.

IDENTIFICATION CODE

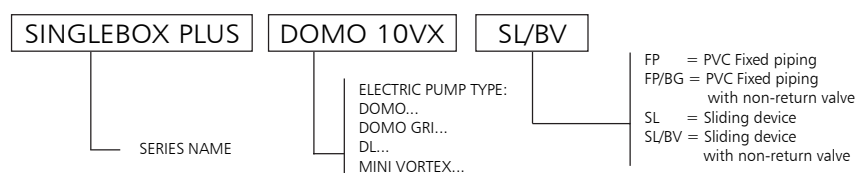

EXAMPLE : SINGLEBOX PLUS DOMO 10VX SL/BV
Lifting station SINGLEBOX PLUS series with DOMO 10VX submersible electric pump with sliding device and non-return valve.

SINGLEBOX PLUS SERIES CHART

SINGLEBOX PLUS		CHARACTERISTICS					FEATURED COMPONENTS			VERSIONS					
		kW	HP	Q max (l/min)	H max (m)	Impeller type	QDR control panel	Float pre-assembled on pump	Float (10 m cable)	Standard with ring nut	Ring nut, non-return valve and gate valve	Standard	With non-return valve		
FIXED PVC PIPE FITTINGS	SINGLE_PHASE	SINGLEBOX PLUS DOMO 7	0,55	0,75	320	10,7	TWIN CHANNEL		X		X	X			
		SINGLEBOX PLUS DOMO 7VX	0,55	0,75	260	9,1	VORTEX		X		X	X			
		SINGLEBOX PLUS DOMO 10	0,75	1	500	10,1	TWIN CHANNEL		X		X	X			
		SINGLEBOX PLUS DOMO 10VX	0,75	1	400	7,7	VORTEX		X		X	X			
		SINGLEBOX PLUS DOMO 15	1,1	1,5	600	12,7	TWIN CHANNEL		X		X	X			
		SINGLEBOX PLUS DOMO 15VX	1,1	1,5	450	9,1	VORTEX		X		X	X			
	SINGLEBOX PLUS DOMO GRI 11	1,1	1,5	110	25	GRINDER		X		X	X				
	THREE_PHASE	SINGLEBOX PLUS DOMO 7T	0,55	0,75	320	10,7	TWIN CHANNEL	X		X	X	X			
		SINGLEBOX PLUS DOMO 7VXT	0,55	0,75	260	9,1	VORTEX	X		X	X	X			
		SINGLEBOX PLUS DOMO 10T	0,75	1	500	10,1	TWIN CHANNEL	X		X	X	X			
		SINGLEBOX PLUS DOMO 10VXT	0,75	1	400	7,7	VORTEX	X		X	X	X			
		SINGLEBOX PLUS DOMO 15T	1,1	1,5	600	12,7	TWIN CHANNEL	X		X	X	X			
		SINGLEBOX PLUS DOMO 15VXT	1,1	1,5	450	9,1	VORTEX	X		X	X	X			
		SINGLEBOX PLUS DOMO 20T	1,5	2	670	14,8	TWIN CHANNEL	X		X	X	X			
		SINGLEBOX PLUS DOMO 20VXT	1,5	2	550	11	VORTEX	X		X	X	X			
		SINGLEBOX PLUS DOMO GRI 11T	1,1	1,5	110	25	GRINDER	X		X	X	X			
		LOWERING DEVICE	SINGLE_PHASE	SINGLEBOX PLUS DOMO 10	0,75	1	500	10,1	TWIN CHANNEL		X			X	X
				SINGLEBOX PLUS DOMO 10VX	0,75	1	400	7,7	VORTEX		X			X	X
				SINGLEBOX PLUS DOMO 15	1,1	1,5	600	12,7	TWIN CHANNEL		X			X	X
	SINGLEBOX PLUS DOMO 15VX			1,1	1,5	450	9,1	VORTEX		X			X	X	
	SINGLEBOX PLUS DOMO GRI 11			1,1	1,5	110	25	GRINDER		X			X	X	
	THREE_PHASE		SINGLEBOX PLUS DOMO 10T	0,75	1	500	10,1	TWIN CHANNEL	X		X		X	X	
			SINGLEBOX PLUS DOMO 10VXT	0,75	1	400	7,7	VORTEX	X		X		X	X	
			SINGLEBOX PLUS DOMO 15T	1,1	1,5	600	12,7	TWIN CHANNEL	X		X		X	X	
SINGLEBOX PLUS DOMO 15VXT			1,1	1,5	450	9,1	VORTEX	X		X		X	X		
SINGLEBOX PLUS DOMO 20T			1,5	2	670	14,8	TWIN CHANNEL	X		X		X	X		
SINGLEBOX PLUS DOMO 20VXT			1,5	2	550	11	VORTEX	X		X		X	X		
SINGLEBOX PLUS DOMO GRI 11T			1,1	1,5	110	25	GRINDER	X		X		X	X		
SINGLE_PHASE			SINGLEBOX PLUS DLFM 80	0,6	0,8	350	7,6	SINGLE CHANNEL		X			X	X	
	SINGLEBOX PLUS DLFM 90		0,6	0,8	450	9,7	MONOCANALE		X			X	X		
	SINGLEBOX PLUS MINI VORTEX M		0,6	0,8	300	7,2	VORTEX		X			X	X		
	SINGLEBOX PLUS DLM 109		1,1	1,5	600	18,3	SINGLE CHANNEL		X			X	X		
	SINGLEBOX PLUS DLVM 100		1,1	1,5	500	10,6	VORTEX		X			X	X		
	THREE_PHASE		SINGLEBOX PLUS DLF 80	0,6	0,8	350	7,6	SINGLE CHANNEL	X		X		X	X	
			SINGLEBOX PLUS DLF 90	0,6	0,8	450	9,7	SINGLE CHANNEL	X		X		X	X	
			SINGLEBOX PLUS MINI VORTEX	0,6	0,8	300	7,2	VORTEX	X		X		X	X	
			SINGLEBOX PLUS DLF 105	1,1	1,5	500	14,1	SINGLE CHANNEL	X		X		X	X	
			SINGLEBOX PLUS DL 109	1,1	1,5	600	18,3	SINGLE CHANNEL	X		X		X	X	
			SINGLEBOX PLUS DLV 100	1,1	1,5	500	10,6	VORTEX	X		X		X	X	
SINGLEBOX PLUS DLF VORTEX			1,1	1,5	500	8,4	VORTEX	X		X		X	X		
SINGLEBOX PLUS DL 125		1,5	2	700	21,9	SINGLE CHANNEL	X		X		X	X			
SINGLEBOX PLUS DLV 115		1,5	2	600	13,1	VORTEX	X		X		X	X			

sboxplus_modelli-en_a_sc

Notes

Single-phase pumps come with start capacitor, overload protection and float switch. Versions with control panel and accessories are available on request.

SINGLEBOX PLUS WITH DOMO-DOMO VX ELECTRIC PUMPS OPERATING CHARACTERISTICS AT 50 Hz

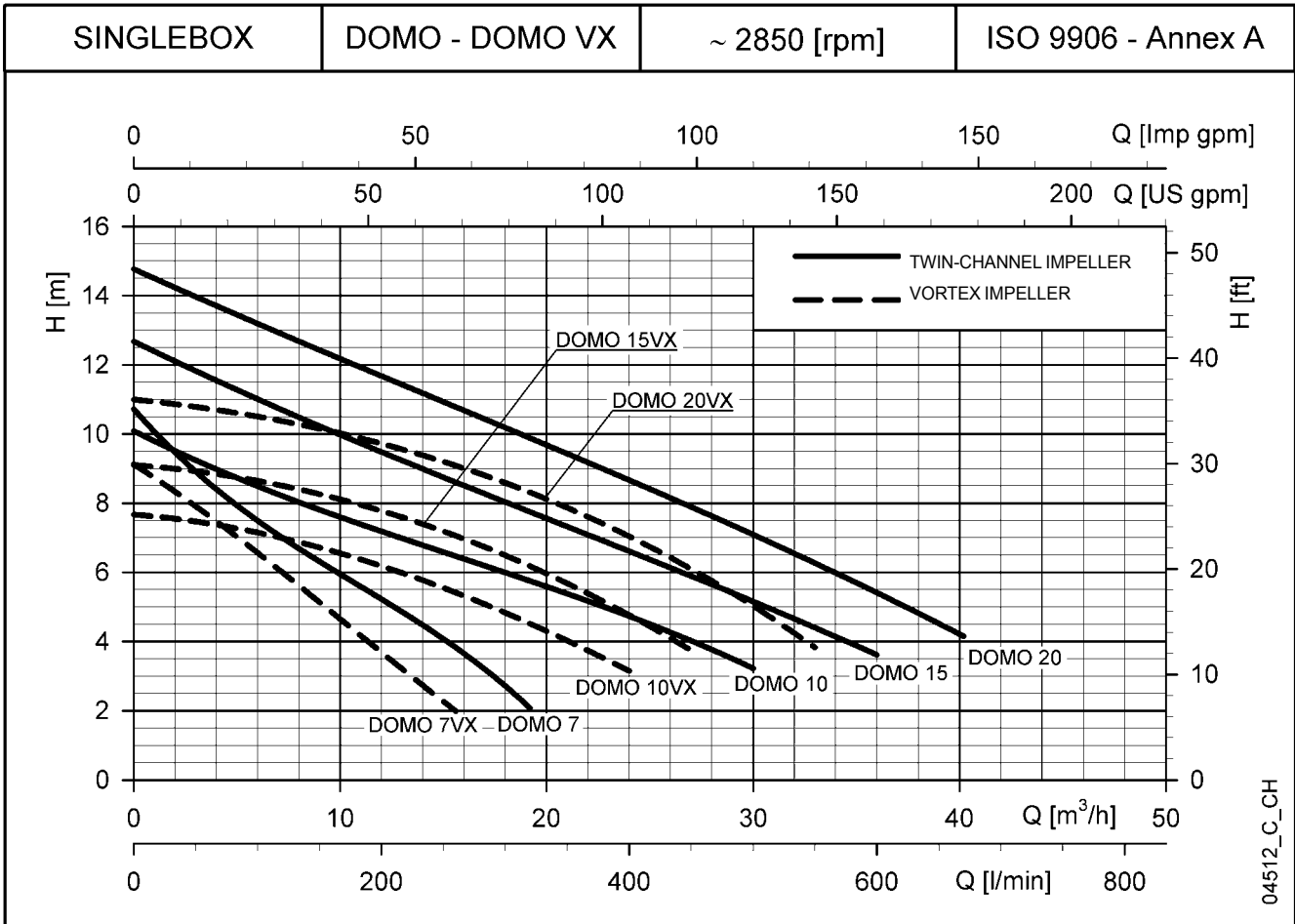

HYDRAULIC PERFORMANCE TABLE

DOMO	PUMP TYPE	RATED POWER		Q = DELIVERY																	
				kW		HP		H = TOTAL HEAD METRES COLUMN OF WATER													
				l/min	m ³ /h	0	50	100	150	200	250	300	320	400	500	600	670				
				0	3	6	9	12	15	18	19,2	24	30	36	40,2						
	DOMO 7(T)	0,55	0,75	10,7	8,9	7,5	6,3	5,2	4,1	2,7	2,1										
	DOMO 10(T)	0,75	1	10,1	9,2	8,5	7,8	7,2	6,6	6,0	5,8	4,7	3,2								
	DOMO 15(T)	1,1	1,5	12,7	11,8	11,0	10,2	9,5	8,8	8,0	7,8	6,6	5,2	3,6							
	DOMO 20T	1,5	2	14,8	14,0	13,2	12,4	11,7	10,9	10,2	9,9	8,7	7,1	5,4	4,2						

DOMO VX	PUMP TYPE	RATED POWER		Q = DELIVERY																	
				kW		HP		H = TOTAL HEAD METRES COLUMN OF WATER													
				l/min	m ³ /h	0	80	100	150	175	200	225	260	300	400	450	550				
				0	4,8	6	9	10,5	12	13,5	15,6	18	24	27	33						
	DOMO 7VX(T)	0,55	0,75	9,1	7,1	6,6	5,1	4,4	3,7	3,0	2,0										
	DOMO 10VX(T)	0,75	1	7,7	7,3	7,1	6,7	6,5	6,2	5,9	5,4	4,8	3,1								
	DOMO 15VX(T)	1,1	1,5	9,1	8,8	8,6	8,3	8,0	7,8	7,5	7,1	6,5	4,8	3,7							
	DOMO 20VXT	1,5	2	11,0	10,6	10,5	10,2	9,9	9,7	9,5	9,1	8,6	7,0	6,1	3,8						

These performances (referred to the single pump) are valid for liquids with density $\rho = 1,0 \text{ kg/dm}^3$ and kinematic viscosity $\nu = 1 \text{ mm}^2/\text{s}$. sbox_domo-domovx-2p50-en_a_th

ELECTRICAL DATA TABLE

PUMP TYPE	ABSORBED POWER*		CAPACITOR
	SINGLE-PHASE		
	kW	220-240 V A	$\mu\text{F} / 450 \text{ V}$
DOMO 7	0,8	3,94	16
DOMO 10	1,14	5,84	22
DOMO 15	1,58	7,02	30
-	-	-	-
DOMO 7VX	0,79	3,91	16
DOMO 10VX	1,15	5,88	22
DOMO 15VX	1,36	6,11	30
-	-	-	-

PUMP TYPE	ABSORBED POWER*		ABSORBED CURRENT*
	THREE-PHASE		
	kW	220-240 V A	380-415 V A
DOMO 7T	0,73	2,58	1,49
DOMO 10T	1,09	4,09	2,36
DOMO 15T	1,49	4,73	2,73
DOMO 20T	1,96	6,6	3,81
DOMO 7VXT	0,71	2,56	1,48
DOMO 10VXT	1,1	4,09	2,36
DOMO 15VXT	1,26	4,31	2,49
DOMO 20VXT	1,74	6,22	3,59

*Maximum values within operating range.

sbox_domo-domovx-2p50-en_a_th

SINGLEBOX PLUS WITH DOMO GRI ELECTRIC PUMPS OPERATING CHARACTERISTICS AT 50 Hz

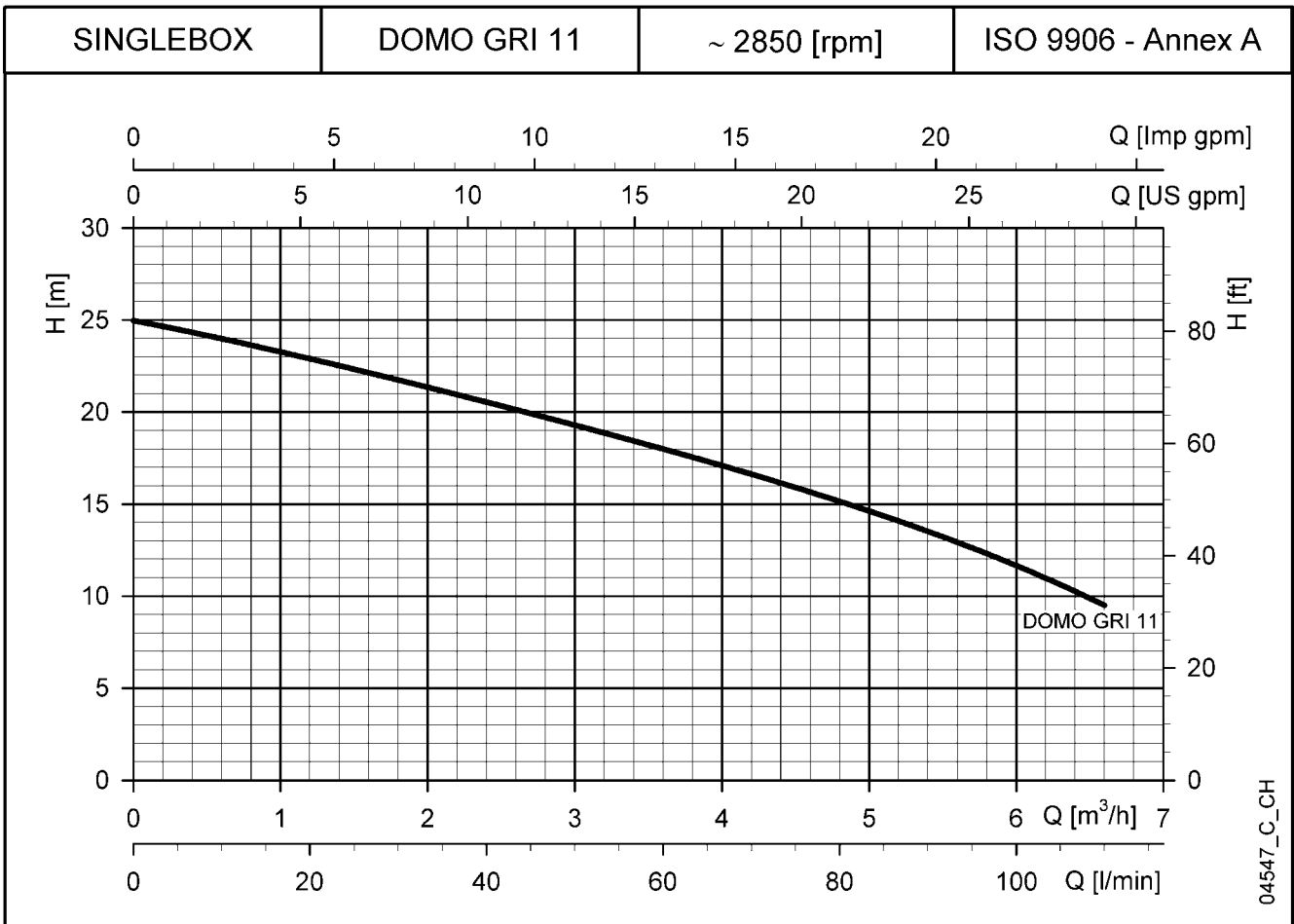

HYDRAULIC PERFORMANCE TABLE

DOMO GRI	PUMP TYPE	RATED POWER		Q = DELIVERY											
				H = TOTAL HEAD METRES COLUMN OF WATER											
				l/min	0	15	30	40	50	60	70	80	90	100	110
				m ³ /h	0	0,9	1,8	2,4	3	3,6	4,2	4,8	5,4	6	6,6
		kW	HP												
	DOMO GRI 11	1,1	1,5	25,0	23,5	21,7	20,5	19,3	18,0	16,6	15,2	13,5	11,7	9,5	
	DOMO GRI 11T														

These performances (referred to the single pump) are valid for liquids with density $\rho = 1,0 \text{ kg/dm}^3$ and kinematic viscosity $\nu = 1 \text{ mm}^2/\text{s}$.

sbox_domo-gri-2p50-en_b_th

ELECTRICAL DATA TABLE

PUMP TYPE	ABSORBED POWER*	ABSORBED CURRENT*	CAPACITOR
SINGLE-PHASE		220-240 V	
	kW	A	$\mu\text{F} / 450 \text{ V}$
DOMO GRI 11	1,5	6,84	30

PUMP TYPE	ABSORBED POWER*	ABSORBED CURRENT*	ABSORBED CURRENT*
THREE-PHASE		220-240 V	380-415 V
	kW	A	A
DOMO GRI 11T	1,39	4,55	2,63

*Maximum values within operating range.

sbox_domo-gri-2p50-en_a_te

SINGLEBOX PLUS WITH DL-DLV ELECTRIC PUMPS OPERATING CHARACTERISTICS AT 50 Hz

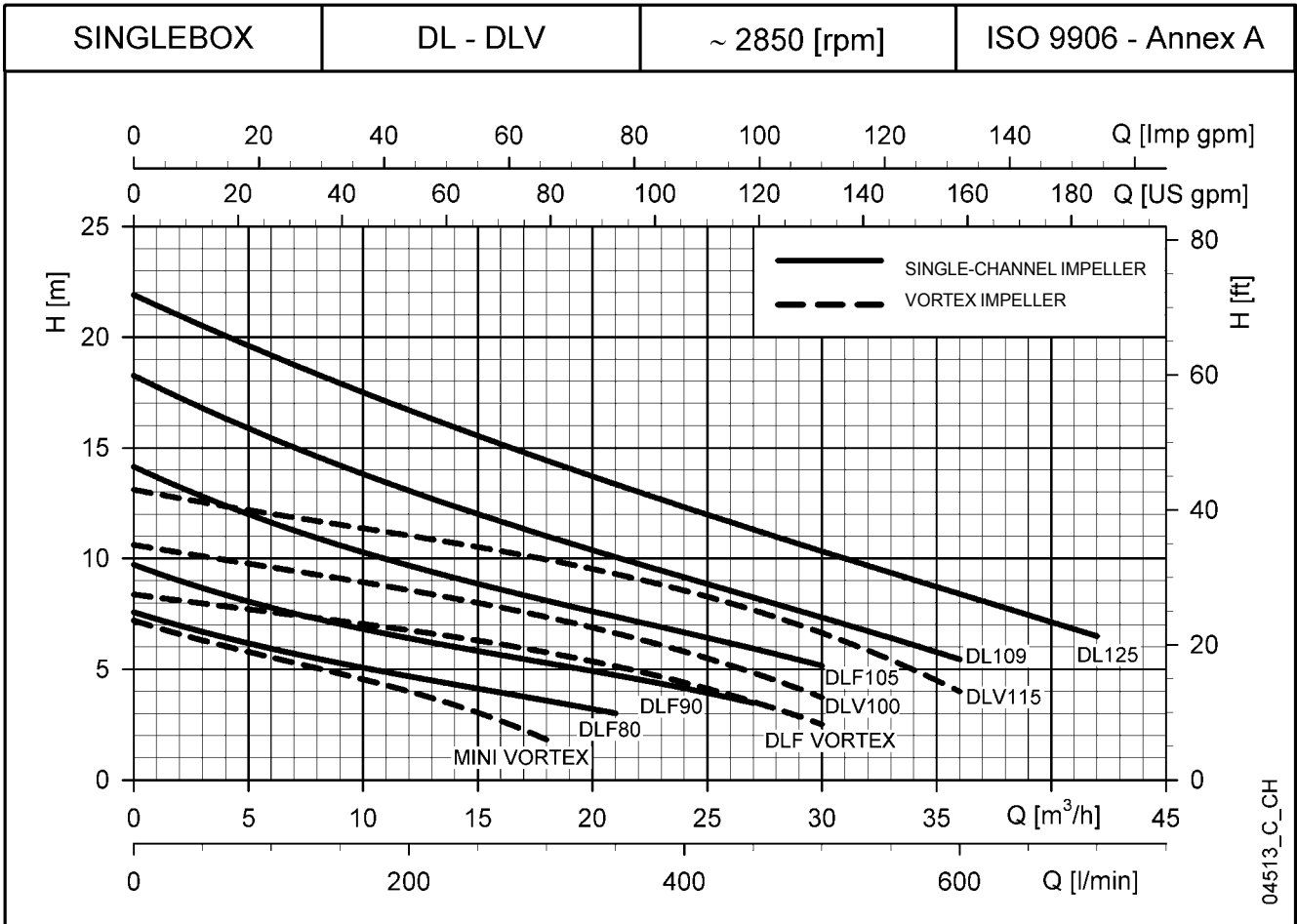

04513_C_CH

HYDRAULIC PERFORMANCE TABLE

DL	PUMP TYPE	RATED POWER		Q = DELIVERY													
				H = TOTAL HEAD METRES COLUMN OF WATER													
				l/min m³/h	0	100	150	200	250	300	350	400	450	500	600	700	
		kW	HP	0	6	9	12	15	18	21	24	27	30	36	42		
	DLF(M) 80	0,6	0,8	7,6	5,9	5,3	4,7	4,1	3,6	3,0							
	DLF(M) 90	0,6	0,8	9,7	7,8	7,0	6,4	5,8	5,3	4,7	4,1	3,5					
	DLF 105	1,1	1,5	14,1	11,6	10,6	9,7	8,9	8,1	7,4	6,7	5,9	5,2				
	DL(M) 109	1,1	1,5	18,3	15,4	14,2	13,1	12,0	11,0	10,1	9,2	8,2	7,3	5,4			
	DL 125	1,5	2	21,9	19,2	17,9	16,7	15,5	14,4	13,4	12,3	11,3	10,3	8,4	6,5		

DLV	PUMP TYPE	RATED POWER		Q = DELIVERY													
				H = TOTAL HEAD METRES COLUMN OF WATER													
				l/min m³/h	0	50	100	150	200	250	300	350	400	450	500	600	
		kW	HP	0	3	6	9	12	15	18	21	24	27	30	36		
	MINI VORTEX(M)	0,6	0,8	7,2	6,3	5,5	4,8	4,0	3,0	1,8							
	DLF VORTEX	1,1	1,5	8,4	8,0	7,6	7,2	6,8	6,3	5,8	5,1	4,4	3,5	2,5			
	DLV(M) 100	1,1	1,5	10,6	10,1	9,6	9,1	8,6	8,0	7,4	6,6	5,8	4,8	3,7			
	DLV 115	1,5	2	13,1	12,5	12,0	11,5	11,0	10,5	9,9	9,3	8,5	7,7	6,6	4,0		

These performances (referred to the single pump) are valid for liquids with density $\rho = 1,0 \text{ kg/dm}^3$ and kinematic viscosity $\nu = 1 \text{ mm}^2/\text{s}$.

sbox_dl-dlv-2p50-en_b_th

ELECTRICAL DATA TABLE

PUMP TYPE	ABSORBED POWER*		CAPACITOR
	ABSORBED POWER*	ABSORBED CURRENT*	
SINGLE-PHASE	kW	220-240 V A	$\mu\text{F} / 450 \text{ V}$
DLFM 80	0,79	3,91	25
DLFM 90	0,89	4,27	25
-	-	-	-
DLM109	1,55	6,87	35
-	-	-	-
MINI VORTEX M	1,05	4,82	25
-	-	-	-
DLVM100	1,64	7,3	35
-	-	-	-

PUMP TYPE	ABSORBED POWER*		ABSORBED CURRENT*
	ABSORBED POWER*	ABSORBED CURRENT*	
THREE-PHASE	kW	220-240 V A	380-415 V A
DLF 80	0,80	-	2,09
DLF 90	0,92	3,81	2,20
DLF 105	1,43	4,66	2,69
DL 109	1,54	5,44	3,14
DL 125	2,14	6,58	3,80
MINI VORTEX	1,10	-	2,36
DLF VORTEX	1,66	5,11	2,95
DLV 100	1,65	5,63	3,25
DLV 115	2,25	6,81	3,93

*Maximum values within operating range.

sbox_dl-dlv-2p50-en_b_te

SINGLEBOX PLUS DIMENSIONS AND WEIGHTS

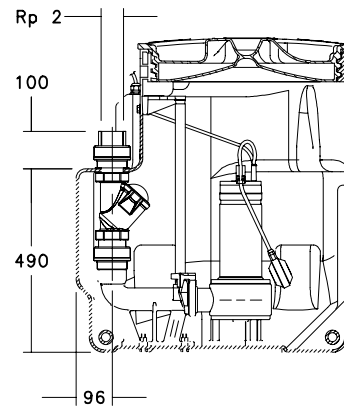
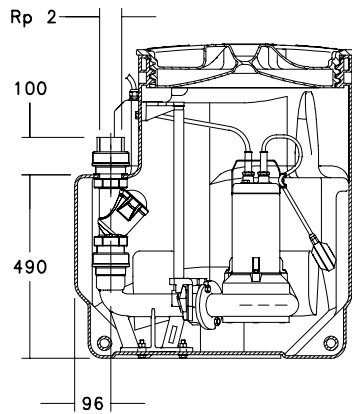
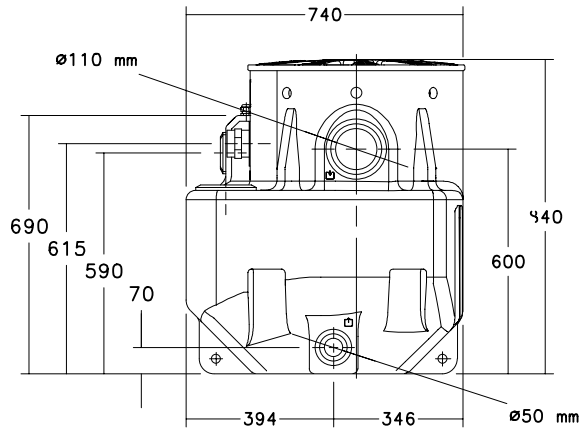
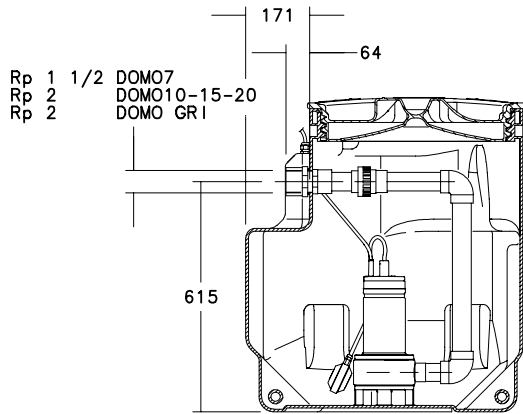

MODEL	WEIGHT (kg)			
	PVC	PVC BV	SL	SL BV
SINGLEBOX PLUS	23	27	32	36

sbox-dbox-en_a_td

04514_C_DD

**SINGLEBOX PLUS - DOUBLEBOX PLUS SERIES
APPLICATION EXAMPLES**

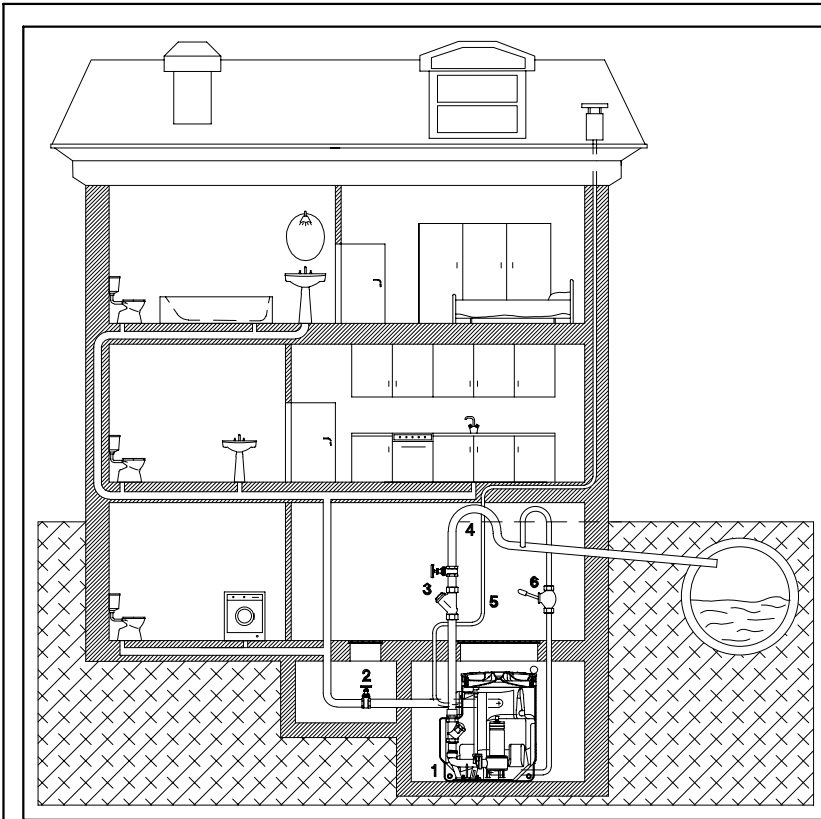

- 1** Lifting station.
- 2** Inlet pipe with gate valve.
- 3** Outlet pipes with non-return valve.
- 4** Drain-trap.
- 5** Vent.
- 6** Emergency drain system with hand-operated pump.

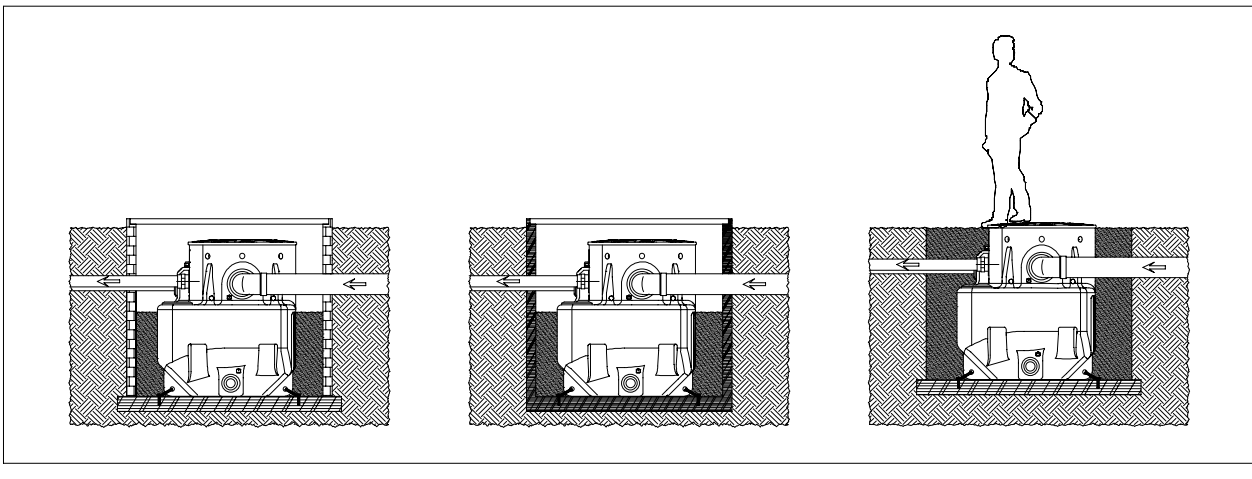
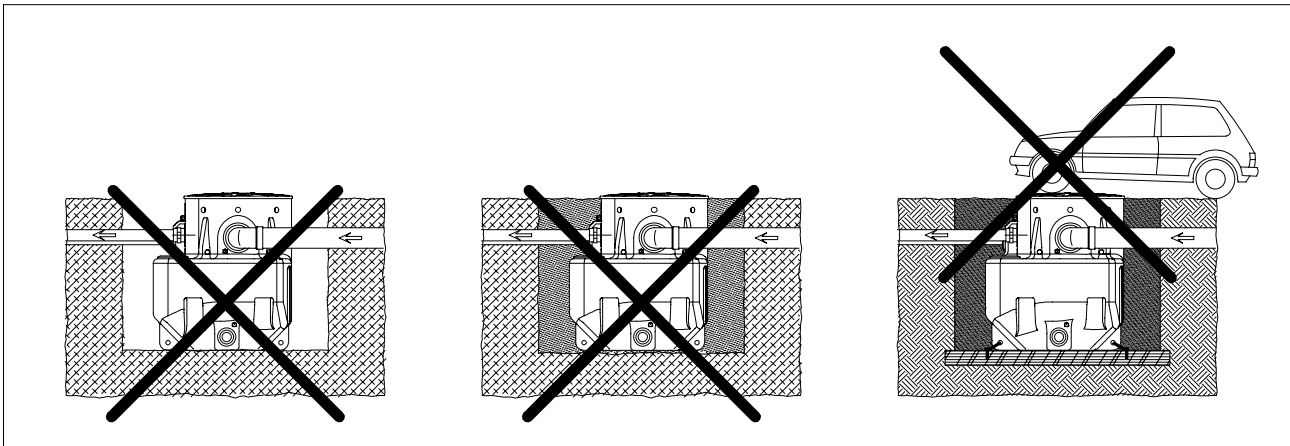

04543_B_SC

SINGLEBOX PLUS - DOUBLEBOX PLUS SERIES CERTIFICATION

MINIBOX MIDIBOX SINGLEBOX PLUS DOUBLEBOX PLUS

Station	Use
MINIBOX DOC3	Clean water
MINIBOX DOC7	Clean water
MINIBOX DOC7VX	Clean water
MIDIBOX DOC3	Clean water
MIDIBOX DOC7	Clean water
MIDIBOX DOC7T	Clean water
MIDIBOX DOC7VX	EN 12050 - 2
MIDIBOX DOC7VXT	EN 12050 - 2
MIDIBOX DOMO7	EN 12050 - 2
MIDIBOX DOMO7T	EN 12050 - 2
MIDIBOX DOMO7VX	EN 12050 - 2
MIDIBOX DOMO7VXT	EN 12050 - 2
SINGLEBOX PLUS / DOUBLEBOX PLUS DOMO 7	EN 12050 - 2
SINGLEBOX PLUS / DOUBLEBOX PLUS DOMO 7T	EN 12050 - 2
SINGLEBOX PLUS / DOUBLEBOX PLUS DOMO 7VX	EN 12050 - 2
SINGLEBOX PLUS / DOUBLEBOX PLUS DOMO 7VXT	EN 12050 - 2
SINGLEBOX PLUS / DOUBLEBOX PLUS DOMO 10	EN 12050 - 1
SINGLEBOX PLUS / DOUBLEBOX PLUS DOMO 10T	EN 12050 - 1
SINGLEBOX PLUS / DOUBLEBOX PLUS DOMO 10VX	EN 12050 - 1
SINGLEBOX PLUS / DOUBLEBOX PLUS DOMO 10VXT	EN 12050 - 1
SINGLEBOX PLUS / DOUBLEBOX PLUS DOMO 15	EN 12050 - 1
SINGLEBOX PLUS / DOUBLEBOX PLUS DOMO 15T	EN 12050 - 1
SINGLEBOX PLUS / DOUBLEBOX PLUS DOMO 15VX	EN 12050 - 1
SINGLEBOX PLUS / DOUBLEBOX PLUS DOMO 15VXT	EN 12050 - 1
SINGLEBOX PLUS / DOUBLEBOX PLUS DOMO 20T	EN 12050 - 1
SINGLEBOX PLUS / DOUBLEBOX PLUS DOMO 20VXT	EN 12050 - 1
SINGLEBOX PLUS / DOUBLEBOX PLUS DOMO GRI 11	EN 12050 - 1
SINGLEBOX PLUS / DOUBLEBOX PLUS DOMO GRI 11T	EN 12050 - 1
SINGLEBOX PLUS / DOUBLEBOX PLUS DLFM 80	EN 12050 - 2
SINGLEBOX PLUS / DOUBLEBOX PLUS DLF 80	EN 12050 - 2
SINGLEBOX PLUS / DOUBLEBOX PLUS DLFM 90	EN 12050 - 2
SINGLEBOX PLUS / DOUBLEBOX PLUS DLF 90	EN 12050 - 2
SINGLEBOX PLUS / DOUBLEBOX PLUS MINI VORTEX M	EN 12050 - 2
SINGLEBOX PLUS / DOUBLEBOX PLUS MINI VORTEX	EN 12050 - 2
SINGLEBOX PLUS / DOUBLEBOX PLUS DLF 105	EN 12050 - 2
SINGLEBOX PLUS / DOUBLEBOX PLUS DLM 109	EN 12050 - 2
SINGLEBOX PLUS / DOUBLEBOX PLUS DL 109	EN 12050 - 2
SINGLEBOX PLUS / DOUBLEBOX PLUS DLVM 100	EN 12050 - 2
SINGLEBOX PLUS / DOUBLEBOX PLUS DLV 100	EN 12050 - 2
SINGLEBOX PLUS / DOUBLEBOX PLUS DLF VORTEX	EN 12050 - 2
SINGLEBOX PLUS / DOUBLEBOX PLUS DL 125	EN 12050 - 2
SINGLEBOX PLUS / DOUBLEBOX PLUS DLV 115	EN 12050 - 2